

PRE-WIRE AUDIO/VIDEO AND TELEVISION with RG-6 COAX

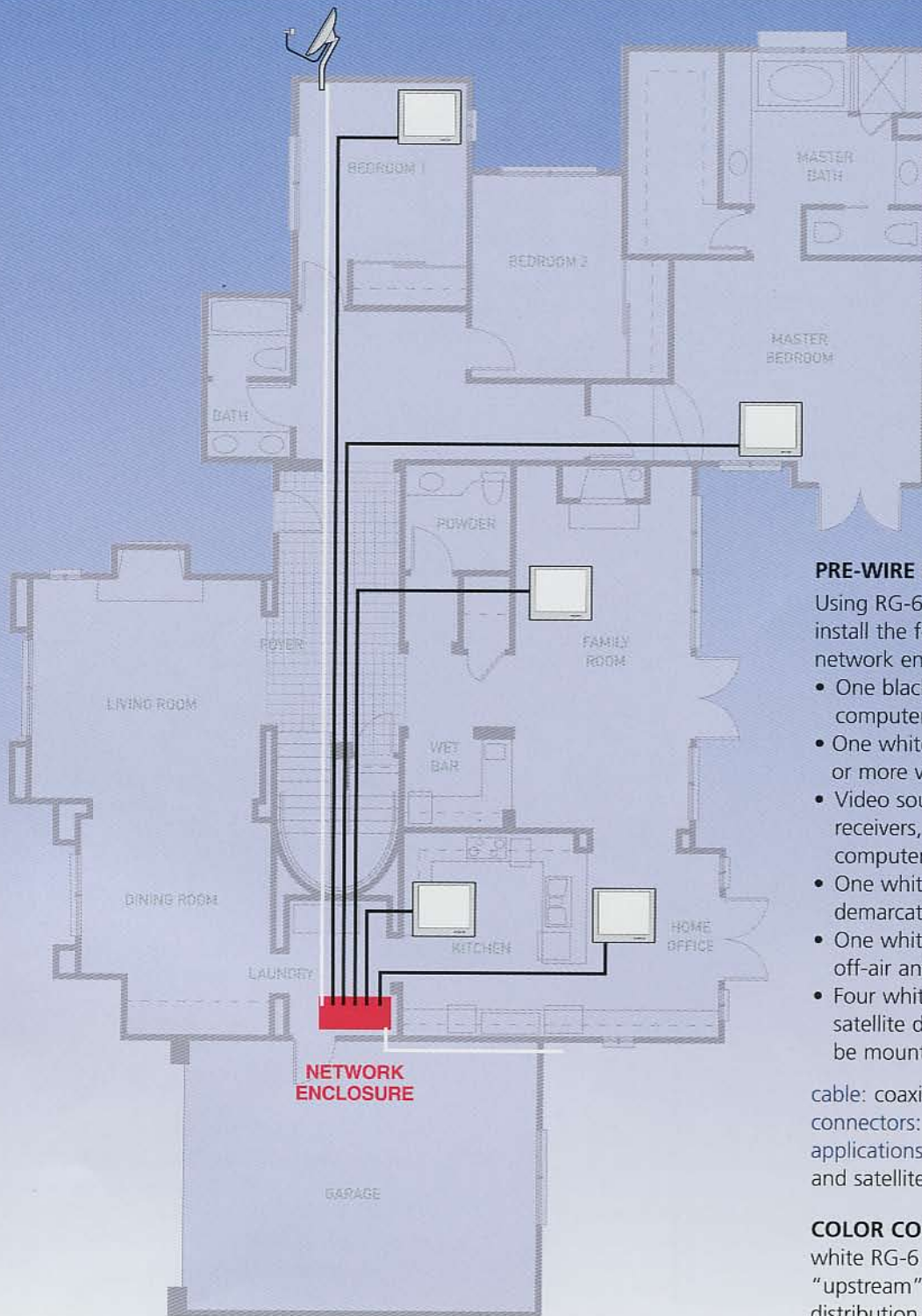

PRE-WIRE GUIDE

Using RG-6 white and black coaxial cable, install the following cable runs from the network enclosure:

- One black coax from each TV or computer location.
- One white coax from everywhere one or more video sources might be located.
- Video sources include VCRs, satellite receivers, TiVo, DVD players, cameras, computers, and Internet TV products.
- One white coax from the CATV demarcation point.
- One white coax to a place where an off-air antenna might be located.
- Four white coax to a place where a satellite dish with a dual LNB might be mounted.

cable: coaxial cable type RG-6 75 Ω
connectors: type F
applications: CATV, antenna, audio/video, and satellite.

COLOR CODING

white RG-6 coax: use as a "send" or "upstream" cable from modulators to distribution panel

black RG-6 coax: use as "receive" or "downstream" cable from distribution panel to TVs