

# PRE-WIRE TELEPHONE, MULTI-ROOM AUDIO, AND SECURITY CAMERAS *with CAT 5 or CAT 5e*

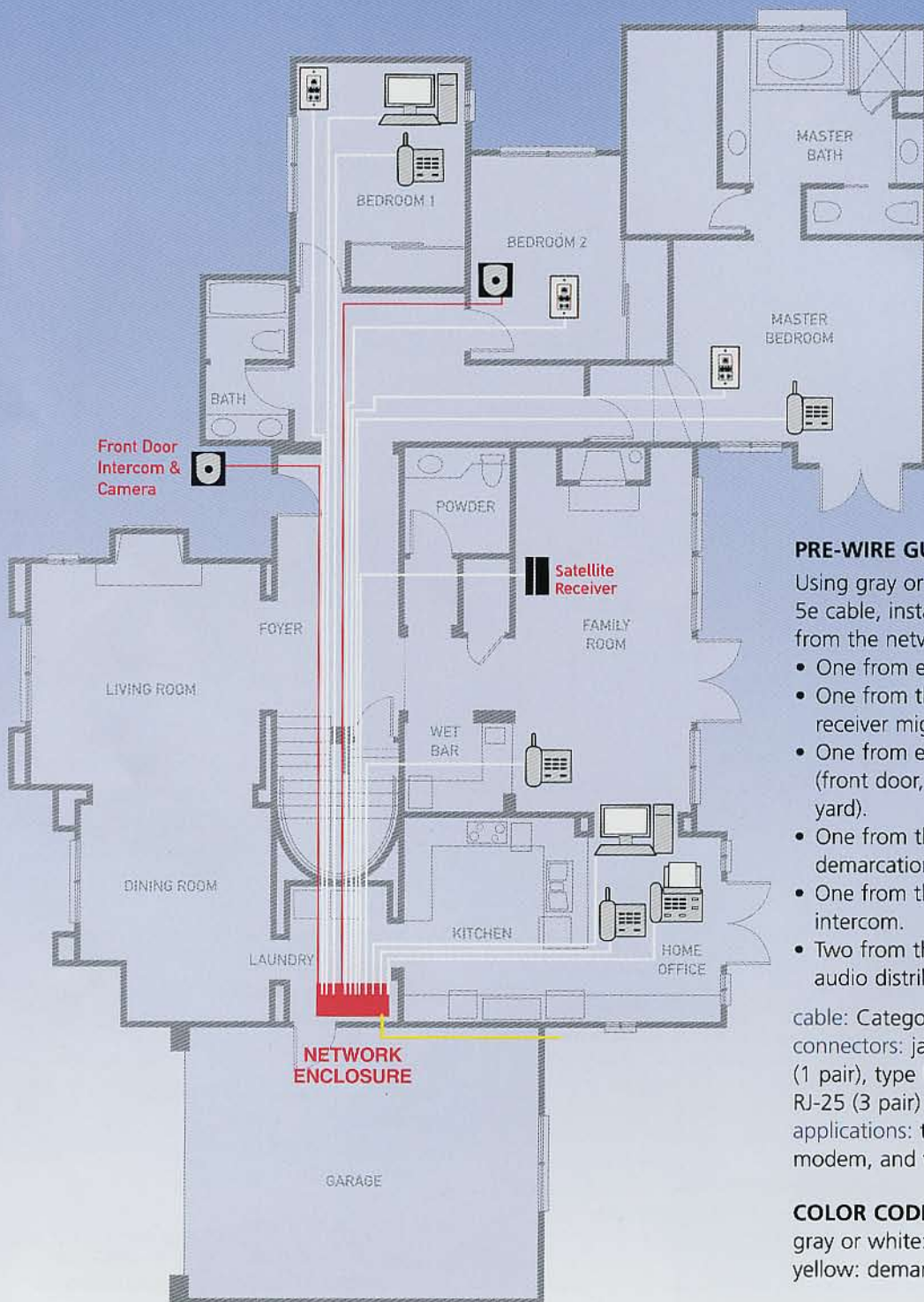

## PRE-WIRE GUIDE

Using gray or white Category 5 or Category 5e cable, install the following cable runs from the network enclosure:

- One from each telephone location.
- One from the location(s) where a satellite receiver might be located.
- One from each video camera location (front door, back door, baby's room, backyard).
- One from the telephone company's demarcation point.
- One from the front door for installing an intercom.
- Two from the media center for video and audio distribution and control.

cable: Category 5 or Category 5e  
connectors: jacks and plugs type RJ-11 (1 pair), type RJ-14 (2 pair), and type RJ-25 (3 pair)

applications: telephone, fax, computer modem, and video cameras

## COLOR CODING

gray or white: telephone  
yellow: demarc and gateway